

1
2 THRU 11

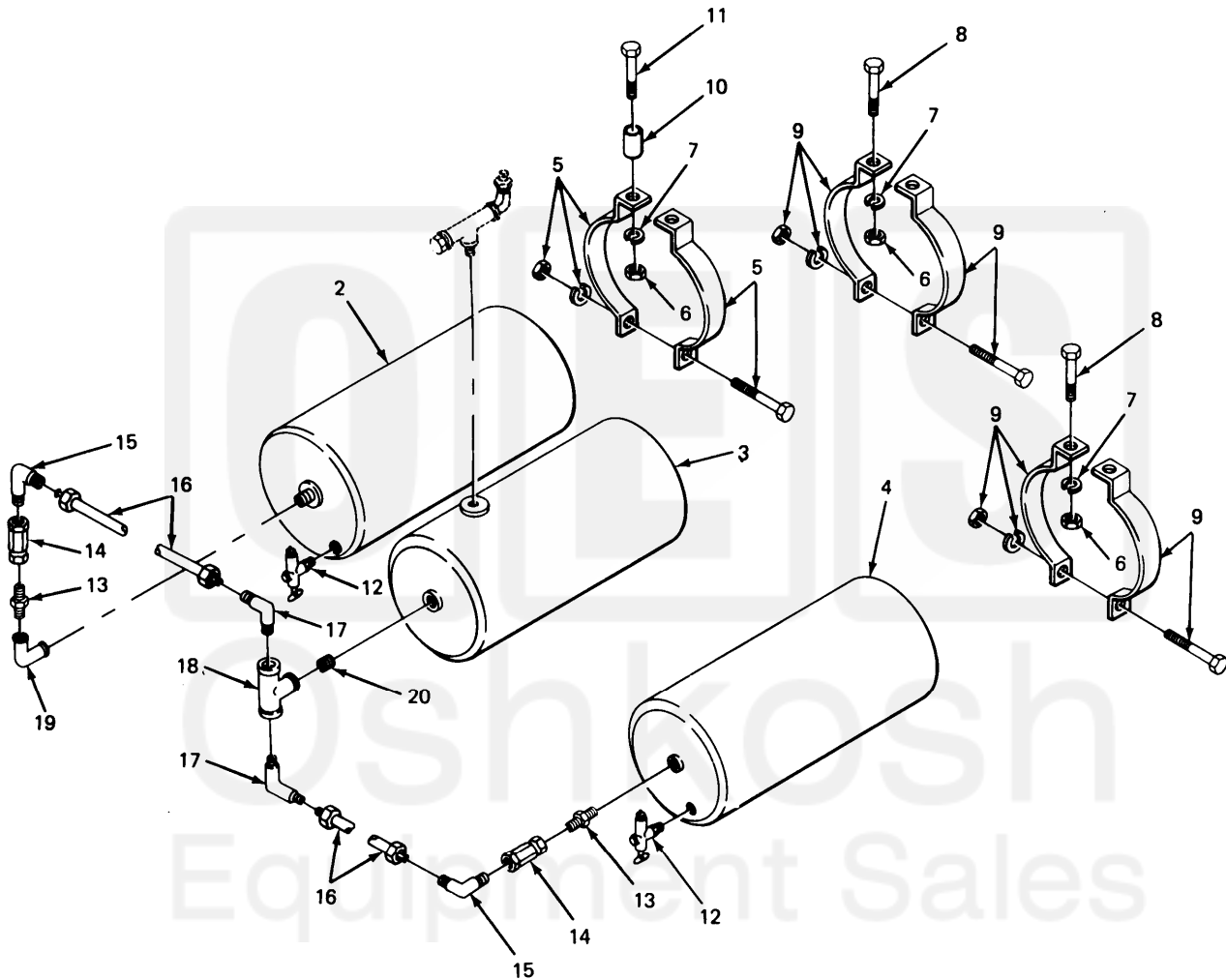

TA212311

FIGURE 177. AIR PRESSURE TANKS AND RELATED PARTS.

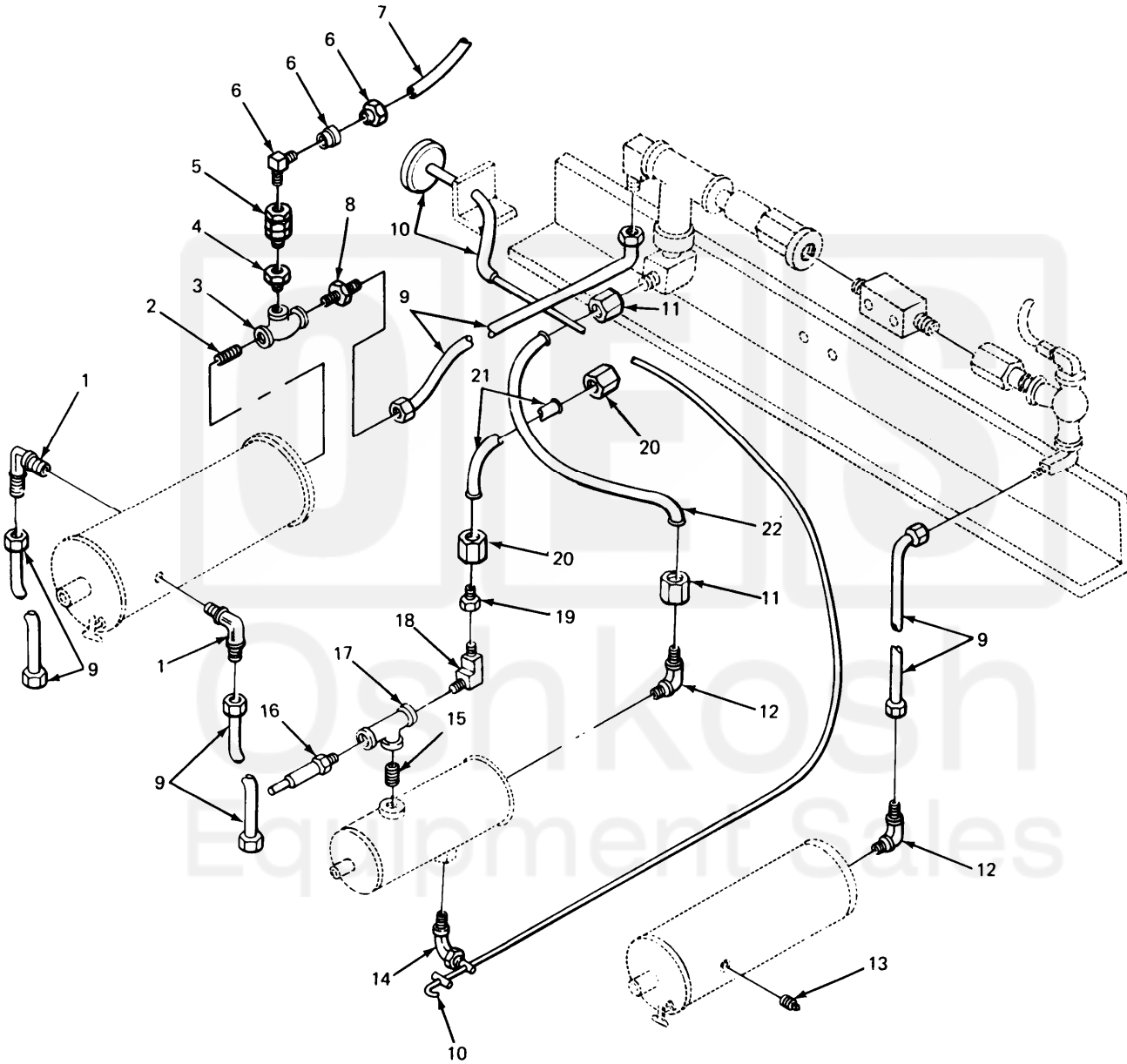

TA212312

FIGURE 178. AIR PRESSURE LINES AND FITTINGS.

Current part is item (14,5,7) on diagram. Available at www.oshkoshequipment.com

SECTION II		TM9-2320-270-34P			
(1)	(2)	(3)	(4)	(5)	(6)
ITEM NO.	SMR CODE	FSCM	PART NUMBER	DESCRIPTION AND USABLE ON CODE (UOC)	QTY
GROUP 1208 AIR BRAKE SYSTEM					
FIG. 178 AIR PRESSURE LINES AND FITTINGS					
1	PAOZZ	81343	10-6 120202BA	ELBOW,PIPE TO TUBE	2
2	PAOZZ	96906	MS51953-97B	NIPPLE,PIPE	1
3	PAOZZ	24617	144086	TEE,PIPE	1
4	PAOZZ	45152	50738-AX	BUSHING,PIPE	1
5	PAOZZ	06853	227788	VALVE,CHECK	1
6	PAOZZ	45152	111993-A	ELBOW,PIPE TO TUBE	1
7	MOOZZ	19207	0144915-140	HOSE,NONMETALLIC AIR RESERVOIR TO FRONT EMERGENCY GLADHAND MAKE FROM HOSE,P/N 246115	1
8	PAOZZ	95019	2-4-533	YOKE,UNIVERSAL JOIN	1
9	MOOZZ	45152	31271AX13	TUBING,NYLON MAKE FROM HOSE,P/N J844DTYPEBSIZE5/8	4
10	PAOZZ	09505	57-R	CONTROL ASSEMBLY,PU	1
11	PAOZZ	01276	4411-12S	ADAPTER,STRAIGHT,TU	2
12	PAOZZ	96906	MS51504A12	ELBOW,PIPE TO TUBE	2
13	PFOZZ	45152	50735AX	PLUG,PIPE	1
14	PAOZZ	21699	452-4000	COCK,DRAIN	1
15	PAOZZ	45152	50739AX	NIPPLE,PIPE	1
16	PAOZZ	56442	BB29157	VALVE,SAFETY RELIEF	1
17	PAOZZ	45152	50734AX	TEE,PIPE	1
18	PAOZZ	45152	47385AX	ELBOW,PIPE TO TUBE	1
19	PAOZZ	45152	50736AX	REDUCER,PIPE	1
20	PAOZZ	45152	13345FX	NIPPLE,TUBE	2
21	MOOZZ	45152	47331AX100U	HOSE,NONMETALLIC MAKE FROM HOSE,P/N 47334AX	1
22	MOOZZ	01276	FC350-12-74U	HOSE,NONMETALLIC MAKE FROM HOSE,P/N FC350-12	1
END OF FIGURE					

Current part is item (14,5,7) on diagram. Available at www.oshkoshequipment.com

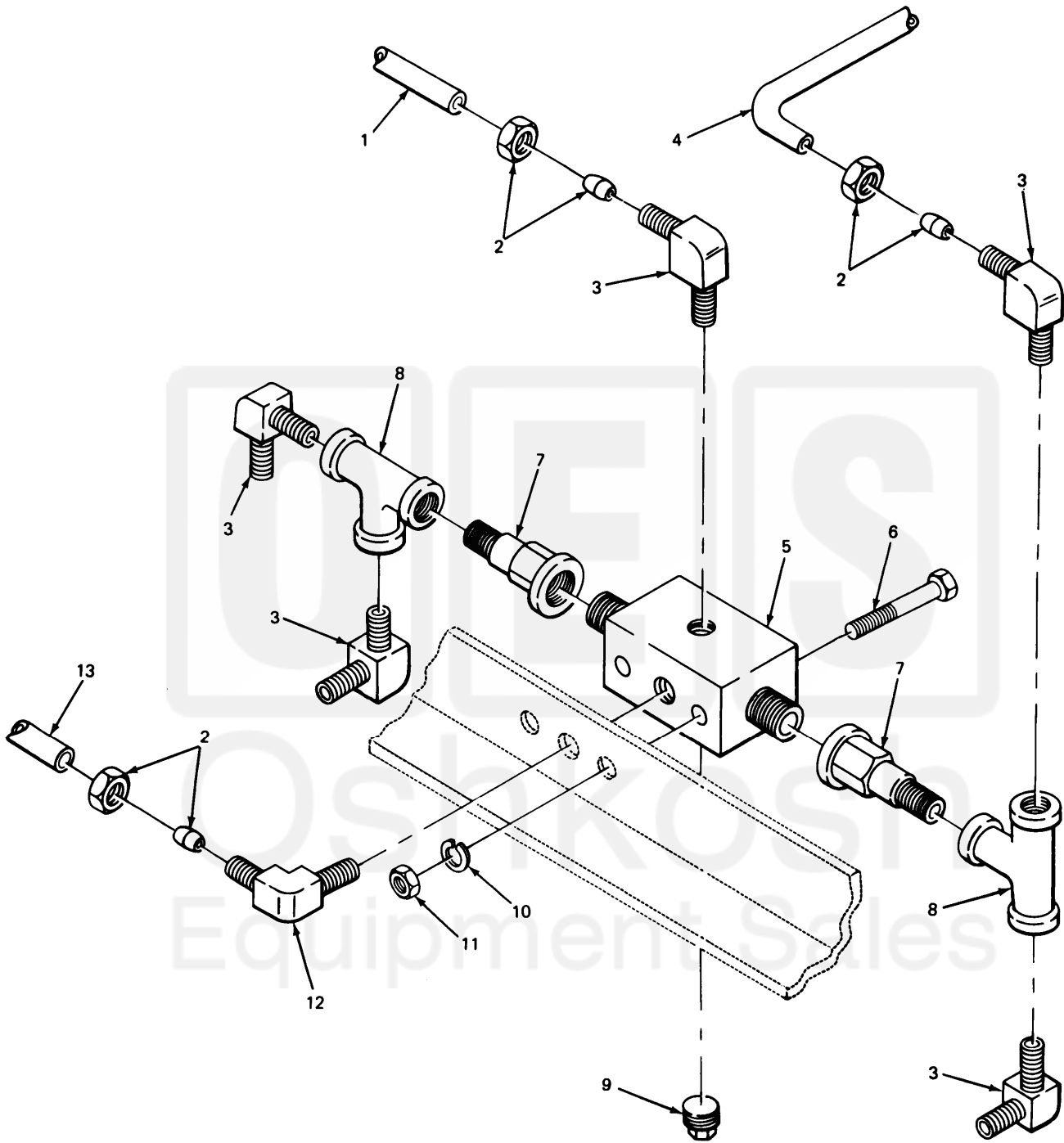

TA212324

FIGURE 192. CHECK VALVE AND FITTINGS.

Current part is item (14,5,7) on diagram. Available at www.oshkoshequipment.com

SECTION II		TM9-2320-270-34P			
(1)	(2)	(3)	(4)	(5)	(6)
ITEM NO.	SMR CODE	FSCM	PART NUMBER	DESCRIPTION AND USABLE ON CODE (UOC)	QTY
GROUP 1208 AIR BRAKE SYSTEM					
FIG. 192 CHECK VALVE AND FITTINGS.					
1	MOOZZ	45152	31271AX237	TUBING,NYLON MAKE FROM HOSE,P/ J844DTYPEBSIZE5/8	1
2	PAOZZ	45152	23344FX	INSERT,TUBE FITTING	4
3	PAOZZ	09505	4-469-F	ELBOW,PIPE TO TUBE	5
4	MOOZZ	45152	31271AX14	TUBING,NYLON MAKE FROM HOSE,P/N J844DTYPEBSIZE5/8	1
5	PFOZZ	45152	54071AX	MANIFOLD,AIR BRAKE	1
6	PAOZZ	96906	MS90728-16	SCREW,CAP,HEXAGON H	2
7	PAOZZ	06853	227788	VALVE,CHECK	2
8	PAOZZ	45152	55340AX	TEE,PIPE	2
9	PAOZZ	19422	BM11352-13-05	PLUG,PIPE	1
10	PAOZZ	96906	MS35338-44	WASHER, LOCK	2
11	PAOZZ	96906	MS51967-2	NUT,PLAIN,HEXAGON	2
12	PAOZZ	81343	6-4 120202BA(LONG NUT)	ELBOW,PIPE TO TUBE	1
13	MOOZZ	45152	23323FX78	HOSE,NONMETALLIC MAKE FROM HOSE,P/ N 246115	1

END OF FIGURE



Current part is item (14,5,7) on diagram. Available at www.oshkoshequipment.com

Current part is item (14,5,7) on diagram. Available at www.oshkoshequipment.com

SECTION II				TM9-2320-270-34P	
(1)	(2)	(3)	(4)	(5)	(6)
ITEM NO.	SMR CODE	FSCM	PART NUMBER	DESCRIPTION AND USABLE ON CODE (UOC)	QTY
				GROUP 1412 HYDRAULIC OR AIR CYLINDERS	
				FIG. 225 CONTROL END HOUSING AND RELATED PARTS.	
1	PFFZZ	62983	219233	SPRING, STEERING VAL	1
2	PFFZZ	62983	219232	SEAT, BALL SOCKET	2
3	KFFZZ	62983	275959	PLUG, ADJUSTING HOUSING, CONTROL END	1
4	KFFZZ	62983	283297	PART OF KIT P/N 922829 HOUSING CONTROL END PART OF KIT P/N 922938	1
5	PAFZZ	62983	224567	BOLT HEAD, HOUSING CONTROL END TO VALVE BODY	4
6	PAOZZ	62983	3X211701	FITTING, LUBRICATION	1
7	PAFZZ	72962	D52NEE-070	NUT, SELF-LOCKING, HE ROD END CLAMPING, CONTROL END HOUSING PART OF KIT P/N 922938	1
8	KFFZZ	62983	276057	PIN HOUSING, CONTROL END PART OF KIT P/N 922829	1
9	KFFZZ	62983	275958	WASHER, PLAIN HOUSING, CONTROL END PART OF KIT P/N 922829	1
10	PAFZZ	96906	MS16625-1087	RING, RETAINING PART OF KIT P/N 922829	1
11	KFFZZ	62983	3X1306	SCREW, CAP, HEXAGON HEAD, ROD END CLAMPING, CONTROL END HOUSING PART OF KIT P/N 922938	1
12	PAFZZ	62983	221589	BOOT, DUST AND MOIST BALL STUD, CONTROL END HOUSING	1
13	PAFZZ	45152	360AX	PIN, COTTER BALL STUD MOUNTING TO DRAG LINK ASSEMBLY	1
14	PAFZZ	96906	MS35692-70	NUT, PLAIN, SLOTTED, H BALL STUD MOUNTING TO DRAG LINK ASSEMBLY	1
15	PFFZZ	62983	219243	STUD, BALL CONTROL END TO DRAG LINK ASSEMBLY	1
				END OF FIGURE	

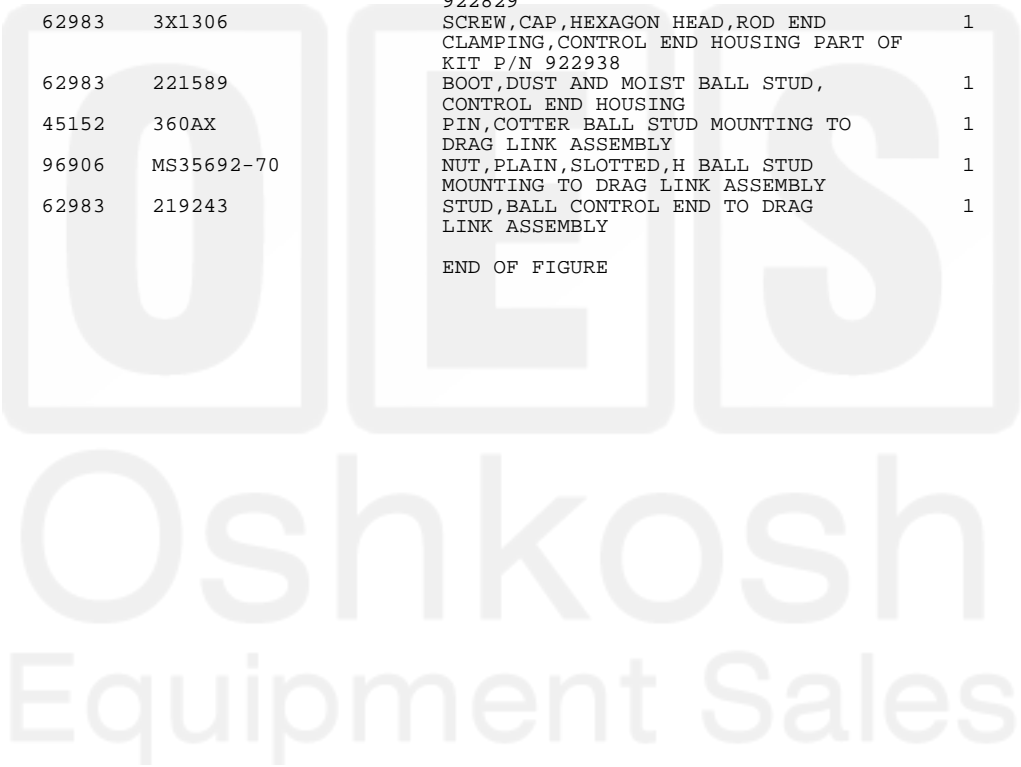

Current part is item (14,5,7) on diagram. Available at www.oshkoshequipment.com